

MAGIC

The Gathering

GRAND PRIX PHOENIX



2017 Travel Guide

Contents

Transportation from Airport to Convention Center.....	p. 3 & 4
Phoenix Convention Center.....	p. 5
Nearby Lodging.....	p. 6
Attractions.....	p. 7
Food List.....	p. 8
Food Map.....	p. 9

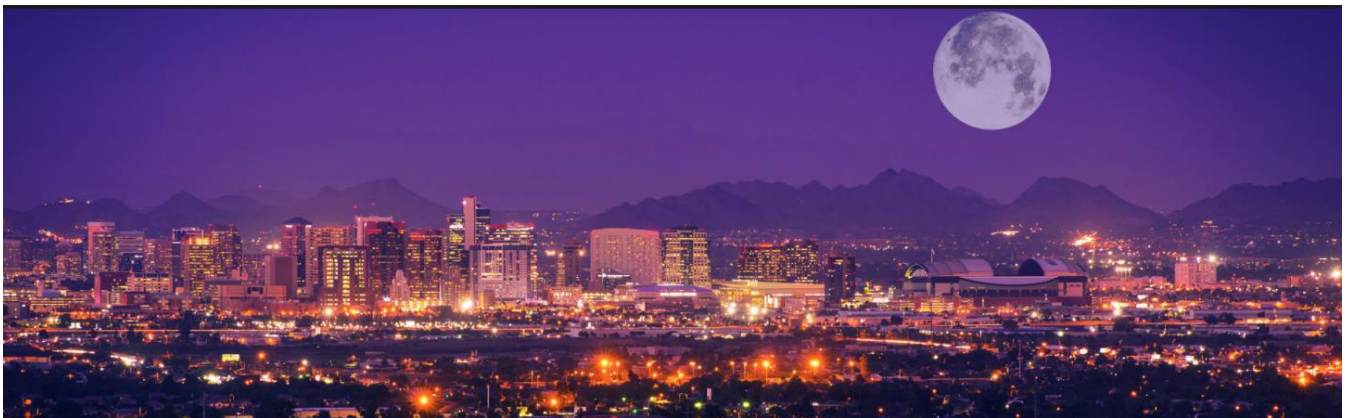

Welcome To Phoenix Sky Harbor Airport

Like most locations, your transportation options are plentiful, and due to the venue being a glorious five and a half miles from the airport, these are my best suggestions:

Public Transportation: \$2.00 & about 30 minutes

- Ask a lovely information person (generally elderly and wearing a purple PHX shirt) where the nearest sky train station is in your terminal and go there.
- The Sky Train is free; you do not need a ticket to board
- Take the Sky Train toward the 44th/Washington Valley Metro Station
- Get off at the last stop and find your way to the West Bound Light Rail station *** you will need to purchase a \$2 one-way ticket at a kiosk ***
- Board the Train and enjoy the ride – you'll get off at the 3rd St and Washington Stop and the venue is just north of the stop, on 3rd St

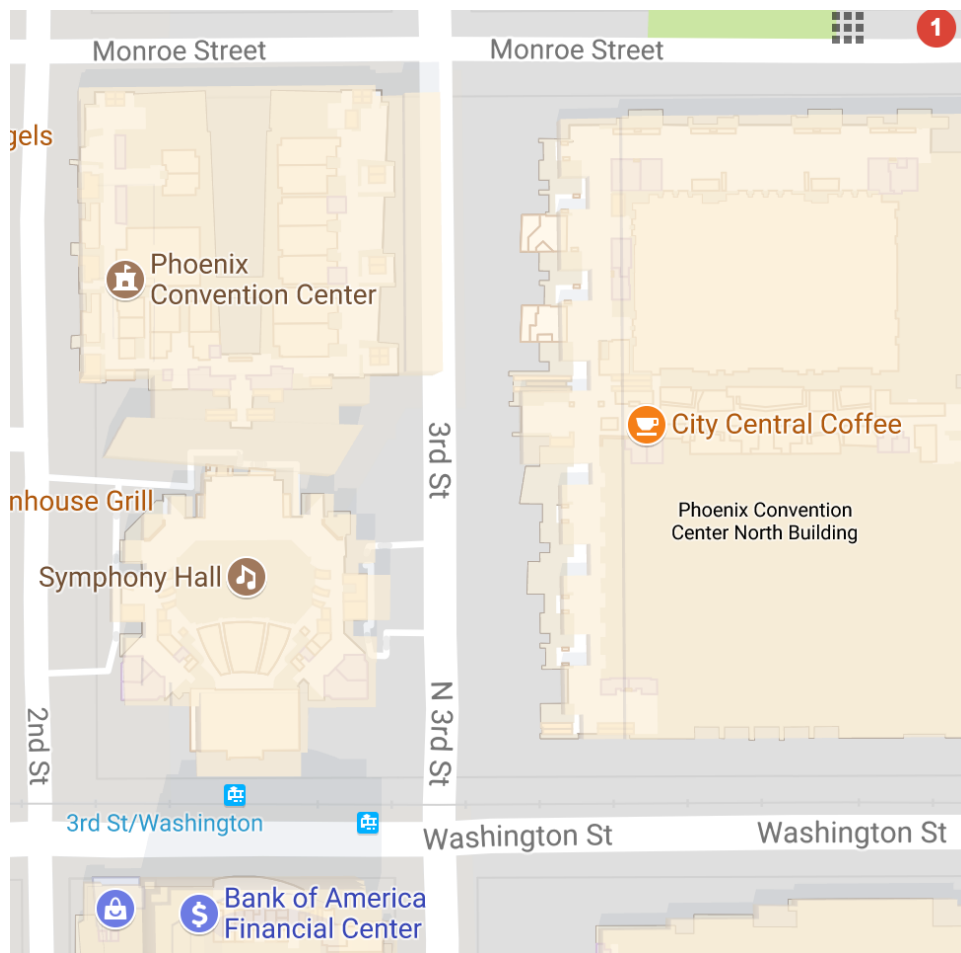

You can also plan your trip on trips.valleymetro.org if going to your hotel.

Transportation Continued...

Uber/Lyft:



Between \$10 – \$15 and 15 – 25 minutes (traveling between 7am – 9am and 3pm – 6pm may increase the time and cost of your trip)

- Each terminal has designated pick-up locations, be sure to select the closest one to you when requesting your ride

Super Shuttle:



\$13+ for a shared shuttle ride using discount code HTW6H at booking.supershuttle.com, time to arrival dependent on other rider sand drop off sequence

- Purchase your ticket in advance using the website above
- The super shuttle counters are often near baggage claim, but if you have trouble locating them, ask one of the lovely information people in the purple shirts
- The Super Shuttle staff will further guide you on where to wait and when you shuttle is ready for you – be sure to tip your driver!

Phoenix Convention Center

Phoenix convention center is large and expands on three of the four corners at the Washington and 3rd Street intersection.

GP Phoenix will be using Exhibit Hall E
Located in the North Building on the third level

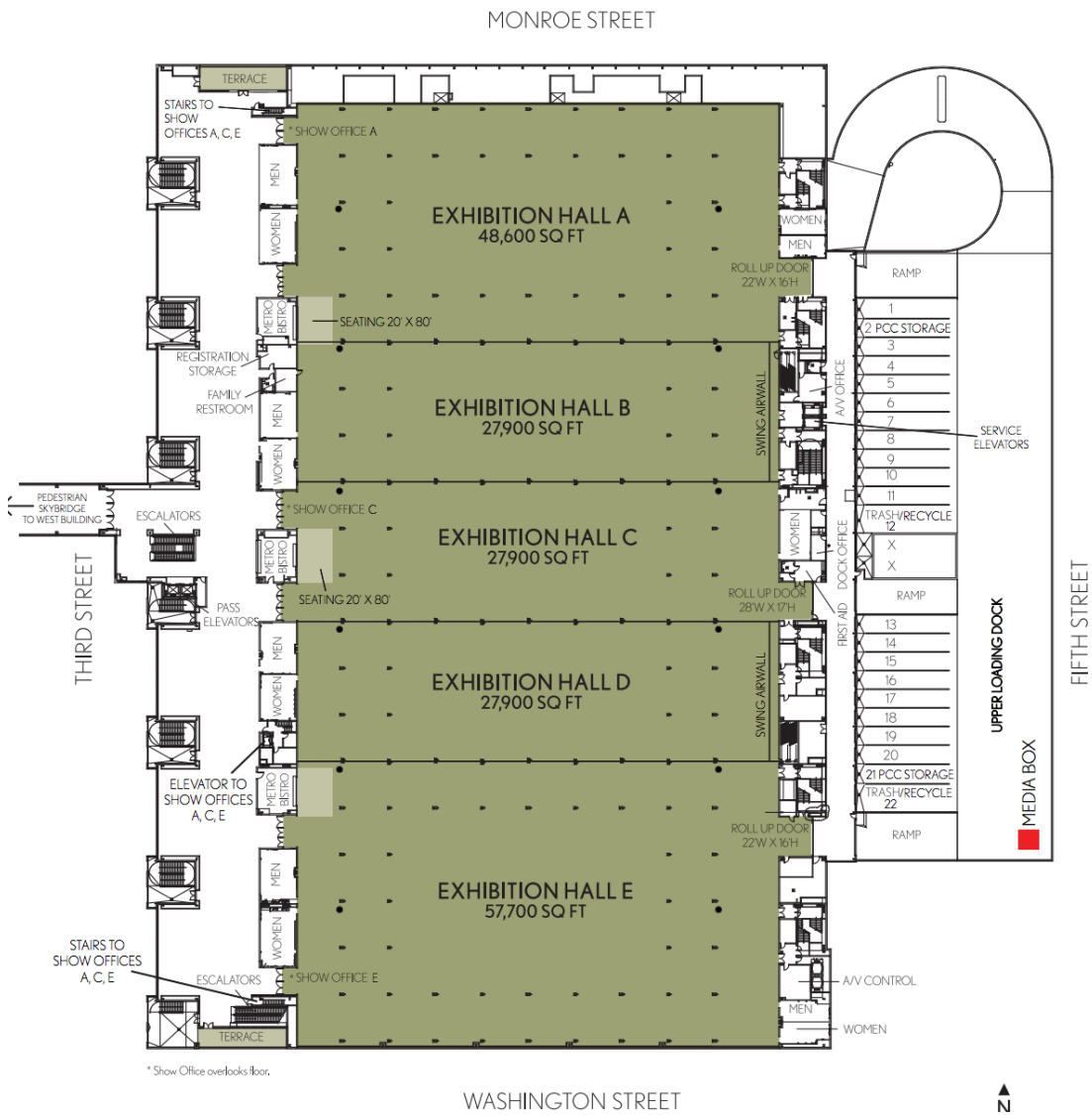

Nearby Lodging

Staff Hotel:

Hilton Phoenix Suites
10 E Thomas Rd
Phoenix, AZ 85012

*** This is a few miles from the venue but easy access via light rail for only \$2 per ride or \$4 per day.

- To get to the venue, board the light rail on Central going south, and get off at 3rd St and Jefferson.
- To get back to the hotel you board going west/north and get off at Central and Thomas.
- There is much to enjoy between this hotel and the venue 😊

Close to the venue:

Hyatt Regency
122 N 2nd St, Phoenix, AZ 85004

Kimpton Hotel Palomar Phoenix
2 E Jefferson St, Phoenix, AZ 85004

Renaissance Phoenix Downtown Hotel
100 N 1st St, Phoenix, AZ 85004

Sheraton Grand Phoenix
340 N 3rd St, Phoenix, AZ 85004

The Westin Phoenix Downtown
333 N Central Ave, Phoenix, AZ 85004

Downtown hotels all start around \$150 - \$200 per night but offer easy access to plenty of food, drink, and enjoyment.

Attractions



Let's be honest with each other, you can go to bars or look at old stuff at museums, or you can enjoy an awesome interactive science center! Arizona Science center is admittedly designed for children, but also offers fun knowledge to all ages.

Open daily from 10am – 5pm

Tickets are \$18 per adult

IMAX experiences are about \$9 each

Purchase tickets at azscience.org



13th Floor Haunted House – Arizona's BEST haunted house experience

Located at Freeway Plaza Shopping Center 2814 W Bell Rd, Phoenix 85053

Tickets are about \$30 per person, doors open at 7pm each night

Purchase tickets at secure.interactiveticketing.com

Food List

All options are within close walking distance, use numbers to locate restaurants/cafes/bars on the map on the following page

1. Chick-Fil-A (closed Sunday)
2. District American Kitchen and Wine Bar
3. Starbucks
4. The Rose and Crown Pub (English Pub)
5. Crave Sandwich Café and Catering
6. Nook Kitchen Downtown (4-6pm happy hour)
7. Melinda's Speakeasy Red Light (Inside Renaissance Hotel)
8. Starbucks
9. Marston's Café (Inside Renaissance Hotel)
10. Einstein Bros Bagels (Inside Hyatt Hotel)
11. Networks Bar and Grill (Inside Hyatt Hotel)
12. City Central Coffee (Inside ground level of Convention Center North)
13. Cartel Coffee Lab *** highly recommended if you love coffee ***
14. Steve's Greenhouse Grill
15. Downtown Pizza Lounge
16. The Kettle Black Kitchen and Pub
17. Kaleidoscope Juice
18. Hanny's
19. Squid Ink Sushi Bar
20. The Arrogant Butcher *** pricey but highly recommended for dinner ***
21. The Strand (pricey but excellent)
22. Chipotle
23. The Breakfast Club *** Highly recommended trendy breakfast ***
24. Bitter & Twisted Cocktail Parlour
25. Tommy Pastrami
26. Hard Rock Café – a classic
27. Dunkin Donuts
28. Vegan House (Vietnamese style food)
29. Valley Bar (live music nightly)
30. Tom Yum Thai
31. Cornish Pasty *** Highly recommended for pasty and beer post shift ***
32. Fair Trade Café (Espresso Bar)

Food Map



Happy GP Weekend! ☺